

# GENERATION

# Road Plates

## User Guide

LW/05.19



GENERATION  
HIRE & SALE  
SCAFFOLDING  
ACCESS  
GROUNDWORKS

Generation UK Ltd  
Trinity Street, Off Tat Bank Road,  
Oldbury, West Midlands, B69 4LA  
Tel: 0800 779 7113  
Email: [enquiries@generationuk.co.uk](mailto:enquiries@generationuk.co.uk)  
[www.generationuk.co.uk](http://www.generationuk.co.uk)

# **GENERATION SCAFFOLDING AND ACCESS SUPPORT FOR CONSTRUCTION AND INDUSTRY**

Generation is the largest UK supplier of access, scaffolding, safety and training products.  
Our customer promise is to deliver the:

## **BEST QUALITY**

We work in partnership with our suppliers to ensure we deliver consistent quality every time. We guarantee that our hire and sales products will meet and conform or exceed all statutory requirements and not let you down.

## **BEST AVAILABILITY**

We have the largest available UK inventory of scaffolding, access and safety products. Our branch network and delivery fleet will ensure that we deliver what you need, when you need it.

## **BEST PARTNERSHIP**

We provide a full range of engineering, design and business services to partner and work with our customers. Talk to us today about how we can help you to grow your business.

## **BEST PRICES**

We use our position as the largest UK supplier of scaffolding products to negotiate the best rates for you. We guarantee you will get the best value products and service when you hire or buy from us.

### **Disclaimer**

Whilst Generation (UK) Ltd has taken every reasonable effort to ensure the information contained within this publication is correct and complete at the time of printing, you should be aware that there will be periodical changes and Generation (UK) Ltd does not accept any liability for any inconvenience, loss or damage caused as a result of any inaccuracy or omission within this publication.

### **Copyright**

No unauthorised reproduction of any images, text or other matter contained herein is permitted. All rights are expressly reserved, including copyright, design right, moral and patent rights (where applicable). We reserve the right to take legal action in respect of any infringement of said rights.

# Contents

## **Specification and Fabrication**

-Road Plate Dimensions.....	4
-Anti-Skid Resistance Coating.....	4
-Aggregates and Finishes.....	5
-UK Safety Standards.....	5

## **Handling and Installation**

-Handling and Moving Road Plates.....	6
-Installation.....	6
-In Service Checks.....	6

## **Storage and Transportation**

-Uninstalling Road Plates.....	7
-Storage and transporting of Road Plates.....	7

# SPECIFICATION AND FABRICATION

## ROAD PLATE DIMENSIONS

All our road plates are available in the following specification.

Code	Description	Weight
420110	8' x 4' - 3/4" Steel Road Plate	420kg
420115	6' x 4' - 3/4" Steel Road Plate	315kg
420112	8' x 4' - 3/4" Anti-Skid Road Plate	420kg
420117	6' x 4' - 3/4" Anti-Skid Road Plate	315kg

Typically, for road works and environments where road plates are installed in the proximity of public and road works, installations are usually for 6ft and 8ft anti-skid road plates.

Maximum plate load up to 5.5 tonne over a maximum trench width of 800mm  
Please always refer to a competent temporary works engineer.

## ANTI-SKID RESISTANCE COATING

All our anti-skid road plates are manufactured using the industry leading, Skid Resistant Surfacing System.

## UK SAFETY STANDARDS

All of the Generation UK anti-skid road plates we manufacture, supply, repair or recondition are tested and verified to meet with all BBA standards and meet all required UK safety standards.

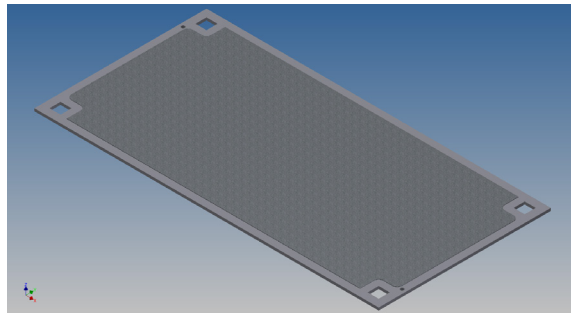

# HANDLING AND INSTALLATION

## HANDLING AND MOVING ROAD PLATES

Steel and anti-skid road plates must be moved and handled with care with the mechanical assistance of a forklift or a crane. It is not recommended to manually handle road plates due to their size and weight, doing so is at the user's own risk.

## INSTALLATION

Steel and anti-skid road plates must always be maneuvered into position with mechanical assistance. Once in the correct location and in position the road plate can then be lowered to the ground and secured.

Securing steel or anti-skid road plates to a road surface is done so by using the anchorage points located at each corner. Where applicable, tapered edges ramps and toe ramps must also be installed and securely fixed to avoid displacement or movement. Also, where applicable, handrails and guardrails should also be installed. This will not be required in all situations. However, events and public areas may require additional safety measures.

All road plates, steel or anti-skid are required by law to be securely fixed to the road surface to avoid any movement, accidents and injuries. It is also a requirement by law that, all authorities and or, contractors must also incorporate regular in-service checks ensuring the road plates are in working condition and free of any defects and damage.

## IN SERVICE CHECKS

Regularly inspect the trench walls to ensure the trafficked units are not overloading them. Check that the units are not moving longitudinally or laterally.

## UNINSTALLING ROAD PLATES

Steel or anti-skid road plates should not be handled solely by one person. Appropriate lifting equipment must be implemented for loading, unloading and installation. They must then be sorted correctly for transport, stacked one on top of the other, with 4" x 4" timber blocks placed between the plates to prevent aggregate and edge defects and damage.

# STORAGE AND TRANSPORTATION

## STORAGE AND TRANSPORT OF STEEL AND ANTI SKID

Steel or anti-skid road plates must be stored correctly when not in use. Failure to do so, will result in defects and damage - rendering your road plate unfit for purpose. Road plates, whether that be steel or anti-skid should be stowed in the following manner:

- Stacked neatly when not in use on a suitable, firm level surface and should be stacked on top of each other, with 4" x 4" timber blocks in between each road plate.
- They should be mechanically maneuvered using cranes or a forklift.
- Regularly checked for damage or defects and kept in a dry area. (if possible)
- Other tools, equipment and machinery should not be stored on top of, or leaning against road plates in storage.
- We also recommend road plates are kept in a secure, lockable area, ideally undercover to help preserve their longevity.

Steel and anti-skid road plates should be stacked as described above, before being securely chained to the transport vehicle. Road plates must be securely fastened to prevent any movement and damage during transit. We strongly advise you give time to correctly load and secure your road plates as the steel edges of road plates can become easily bent, warped and damaged during transit.

Any other queries please contact your local branch.

# NOTES

Hire and Sale Branches Freephone:  
**0800 779 7113**

### **Birmingham (West)**

Trinity Street Off Tat Bank Road,  
 Oldbury, West Midlands, B69 4LA  
 T: 0121 544 3355 F: 0121 544 3131  
 E: [birmingham@generationuk.co.uk](mailto:birmingham@generationuk.co.uk)

### **Birmingham (East) G**

87-93 Amington Road, Birmingham,  
 West Midlands, B25 8ET  
 T: 0121 706 0000 F: 0121 706 9832  
 E: [birminghameast@generationuk.co.uk](mailto:birminghameast@generationuk.co.uk)

### **Bristol**

Unit 7, 12-16 Foundry Lane, Fishponds,  
 Bristol, B55 7UE  
 T: 0117 972 4550 F: 0117 972 4502  
 E: [bristol@generationuk.co.uk](mailto:bristol@generationuk.co.uk)

### **Cardiff**

Martin Road, Tremorfa Industrial Estate  
 Cardiff, CF24 5SD  
 T: 029 2046 3835 F: 029 2046 3246  
 E: [cardiff@generationuk.co.uk](mailto:cardiff@generationuk.co.uk)

### **Edinburgh**

4 Westerton Road,  
 East Mains Industrial Estate, Broxburn,  
 West Lothian, EH52 5AU  
 T: 01506 863 864 F: 01506 863 916  
 E: [edinburgh@generationuk.co.uk](mailto:edinburgh@generationuk.co.uk)

### **Frimley (West London)**

22-30 Sturt Road, Frimley Green  
 Camberley, GU16 6HY  
 T: 01252 838 696 F: 01252 837 614  
 E: [frimley@generationuk.co.uk](mailto:frimley@generationuk.co.uk)

### **Gateshead G**

Stonegate Lane, Abbotsford Road,  
 Felling, Gateshead, NE10 0EX  
 T: 0191 469 7504 F: 0191 469 8237  
 E: [gateshead@generationuk.co.uk](mailto:gateshead@generationuk.co.uk)

### **Glasgow**

Duchess Road, Rutherglen  
 Glasgow, G73 1AU  
 T: 0141 647 6969 F: 0141 647 5851  
 E: [glasgow@generationuk.co.uk](mailto:glasgow@generationuk.co.uk)

### **Grays G**

Europa Business Park, Magnet Road,  
 Grays, Essex, RM20 4DB  
 T: 01375 312 120 F: 01375 386 844  
 E: [grays@generationuk.co.uk](mailto:grays@generationuk.co.uk)

### **Leeds**

Unit 2 Ledger Park, Haigh Park Road,  
 Stourton, Leeds LS10 1RT  
 T: 0113 277 8822 F: 0113 277 7545  
 E: [leeds@generationuk.co.uk](mailto:leeds@generationuk.co.uk)

### **London (East)**

Unit H, Hangman's Wood Ind Park,  
 Stifford Road, South Ockendon,  
 Essex, RM15 6RL  
 T: 020 7473 6056 F: 01708 858 493  
 E: [london@generationuk.co.uk](mailto:london@generationuk.co.uk)

### **Newcastle**

Forward House, Portobello Road  
 Portobello Industrial Estate, Birtley,  
 Tyne and Wear, DH3 2SN  
 T: 0191 492 1190 F: 0191 411 1148  
 E: [newcastle@generationuk.co.uk](mailto:newcastle@generationuk.co.uk)

### **Northampton**

Kingsfield Way, Dallington,  
 Northampton, NN5 7QN  
 T: 01604 580 444 F: 01604 580 487  
 E: [northampton@generationuk.co.uk](mailto:northampton@generationuk.co.uk)

### **Salsburgh G**

Duntilland Road, Shotts, Salsburgh,  
 North Lanarkshire, ML7 4NZ  
 T: 01698 870 200 F: 01698 870 159  
 E: [salsburgh@generationuk.co.uk](mailto:salsburgh@generationuk.co.uk)

### **Stockport**

Unit 4 Vauxhall Industrial Estate,  
 Greg Street, Reddish,  
 Stockport, SK5 7BR  
 T: 0161 477 0131 F: 0161 477 7618  
 E: [stockport@generationuk.co.uk](mailto:stockport@generationuk.co.uk)

### **West Thurrock (East London)**

4 Riverside Ind. Park, Oliver Road,  
 West Thurrock, RM20 3ED  
 T: 020 7476 4760 F: 020 7476 3157  
 E: [westthurrock@generationuk.co.uk](mailto:westthurrock@generationuk.co.uk)

### **Widnes G**

Pitt Street, West Bank, Widnes,  
 Cheshire, WA8 0TG  
 T: 0151 420 3331 F: 0151 495 2298  
 E: [widnes@generationuk.co.uk](mailto:widnes@generationuk.co.uk)

---

### **Altrad Training Services**

Unit 20B Greens Industrial Park,  
 Calder Vale Road, Wakefield, WF1 5PH  
 T: 01924 370 640 F: 01924 377 530  
 Freephone: 0800 587 5224  
 E: [training@altraduk.co.uk](mailto:training@altraduk.co.uk)

---

### **Generation Export**

Trinity Street, Off Tat Bank Road  
 Oldbury, West Midlands, B69 4LA  
 T: +44 (0) 121 543 2964  
 E: [export@generationuk.co.uk](mailto:export@generationuk.co.uk)

---

### **Generation UK Head Office**

Trinity Street, Off Tat Bank Road  
 Oldbury, West Midlands, B69 4LA  
 T: 0121 543 2950 F: 0121 543 2953  
 E: [enquiries@generationuk.co.uk](mailto:enquiries@generationuk.co.uk)

**G** GROUNDWORKS



GENERATION UK Ltd  
 Generation Head Office, Trinity Street, Off Tat Bank Road, Oldbury, West Midlands, B69 4LA - United Kingdom  
 Tel. 0121 543 2950 - Fax. 0121 543 2953 - [enquiries@generationuk.co.uk](mailto:enquiries@generationuk.co.uk)  
[www.generationuk.co.uk](http://www.generationuk.co.uk)